

Land Use Bylaw 3357/2006



North

Scale 1:5,000

© The City of Red Deer



	Land Use District Boundary		Historical Preservation Sites
R1	Land Use District		Historically Significant Sites
	Exception to District	1000	Historical Site Number
0101	Exception Number	---	City Boundary
•••	Exempted from District	123	Civic Address
2a	Exempted Number	+	Railway
V18	Height Overlay District	---	Proposed Lots
D95	Density Overlay District		
s	Secondary Suite Permitted		

Printed on Jun 18, 2013

Land Use Districts

T13

NE¼ Sec12 38-27-W4

Refer to Constraints Map

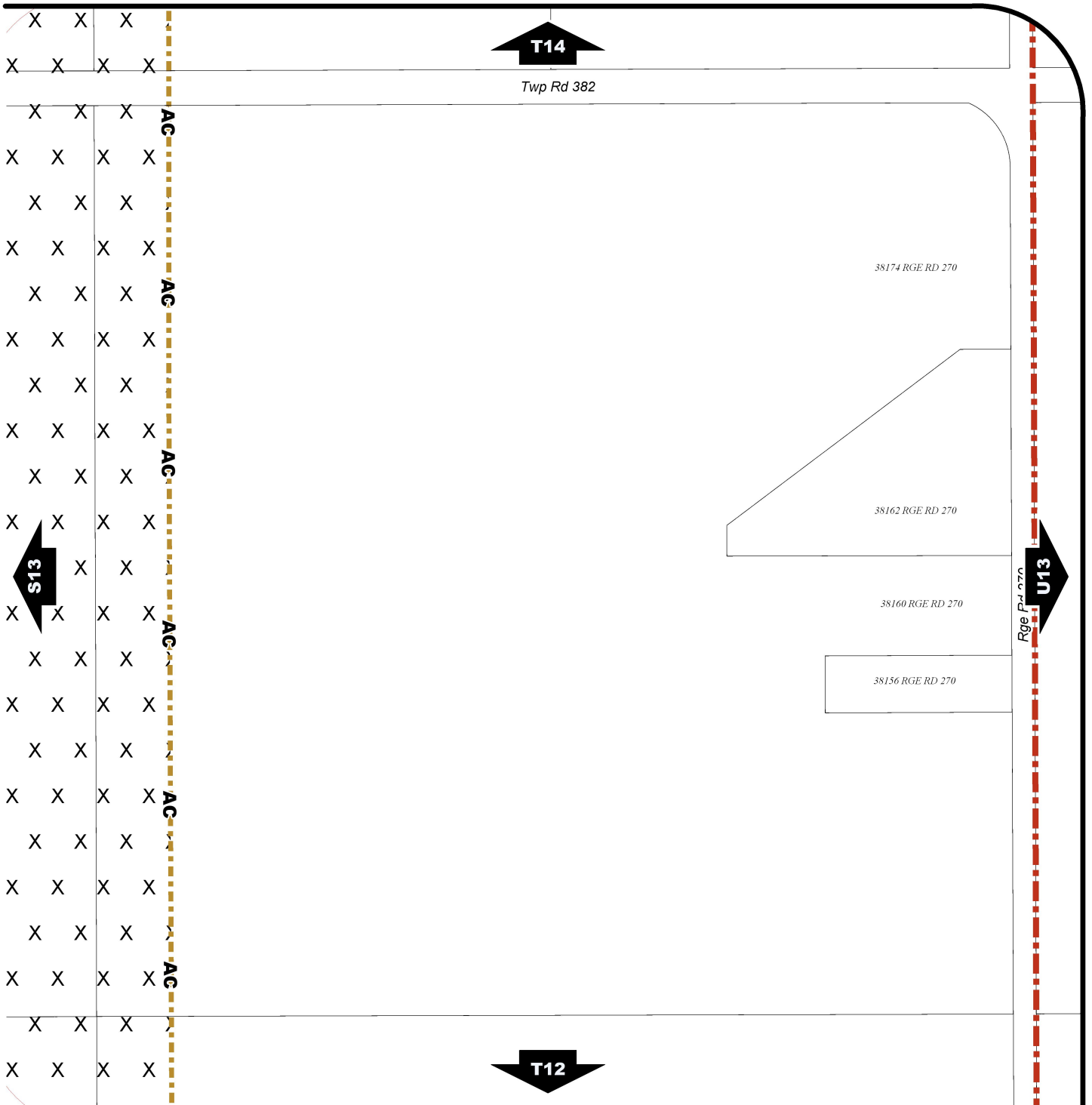

Land Use Bylaw 3357/2006



North

Scale 1:5,000

© The City of Red Deer



- | | | | |
|--|--|--------------|--------------------------------|
| | Escarpment Area | | Gaetz - Ross Heritage Area |
| | Flood Fringe | | Business Revitalization Zone |
| | Floodway | | Historical Preservation Sites |
| | Landfill Site (approximate) | | Historically Significant Sites |
| | Landfill Setback | <i>HP-32</i> | Historical Site Number |
| | Major Entry Area | | City Boundary |
| | TransCanada Pipeline Setback | <i>123</i> | Civic Address |
| | AltaLink Consultation/Potential Constraints Area | | Railway |
| | Overlay District | | Proposed Lots |

Printed on Jun 18, 2013

Land Use Constraints

T13

NE¼ Sec12 38-27-W4