

Land Use Bylaw 3357/2006



North

Scale 1:5,000

© The City of Red Deer



	Land Use District Boundary		Historical Preservation Sites
<i>R1</i>	Land Use District		Historically Significant Sites
	Exception to District	<i>HP-32</i>	Historical Site Number
<i>e(ii)</i>	Exception Number		City Boundary
	Exempted from District	<i>123</i>	Civic Address
<i>2a</i>	Exempted Number		Railway
V18	Height Overlay District		Proposed Lots
D95	Density Overlay District		
s	Secondary Suite Permitted		

Printed on Mar 20, 2015

Land Use Districts

R19

NE¼ Sec26 38-27-W4

Refer to Constraints Map

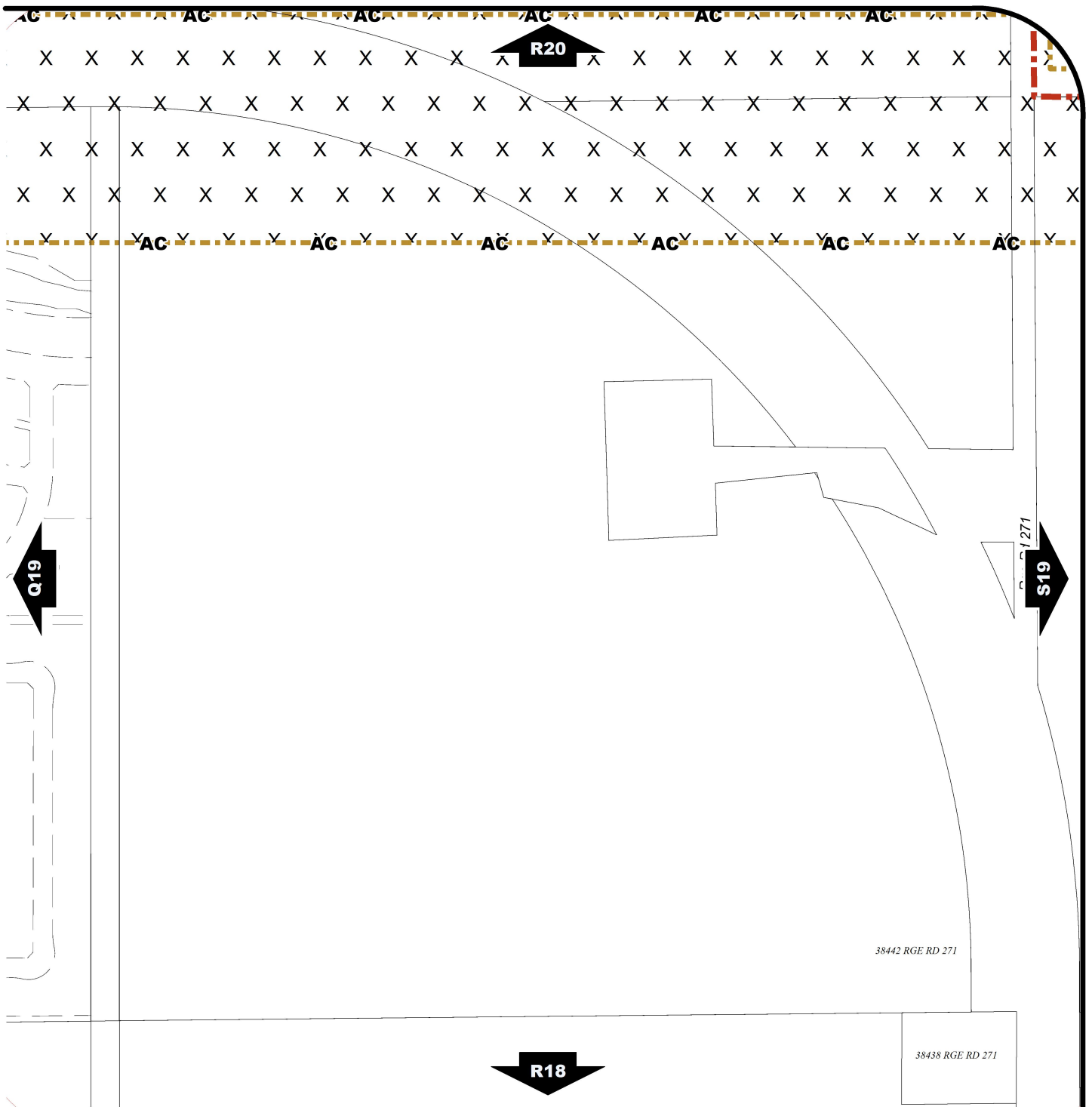

Land Use Bylaw 3357/2006



North

Scale 1:5,000

© The City of Red Deer



- | | |
|--|-------------------------------------|
| Escarpment Area | Subdivision Consideration |
| Flood Fringe | Restricted Development Area |
| Floodway | Business Revitalization Zone |
| Landfill Site (approximate) | Historical Preservation Sites |
| Landfill Setback | Historically Significant Sites |
| Major Entry Area | <i>HP-32</i> Historical Site Number |
| TransCanada Pipeline Setback | --- City Boundary |
| AltaLink Consultation/Potential Constraints Area | <i>123</i> Civic Address |
| Overlay District | --- Railway |
| Gaetz - Ross Heritage Area | --- Proposed Lots |

Printed on Mar 20, 2015

Land Use Constraints

R19

NE¼ Sec26 38-27-W4