

Land Use Bylaw 3357/2006



North

Scale 1:5,000

© The City of Red Deer



| | | | |
|--------------|----------------------------|--------------|--------------------------------|
| | Land Use District Boundary | | Historical Preservation Sites |
| <i>R1</i> | Land Use District | | Historically Significant Sites |
| | Exception to District | <i>HP-32</i> | Historical Site Number |
| <i>e(ii)</i> | Exception Number | | City Boundary |
| | Exempted from District | <i>123</i> | Civic Address |
| <i>2a</i> | Exempted Number | | Railway |
| V18 | Height Overlay District | | Proposed Lots |
| D95 | Density Overlay District | | |
| s | Secondary Suite Permitted | | |

Printed on Nov 07, 2014

Land Use Districts

P18

SE¼ Sec27 38-27-W4

Refer to Constraints Map

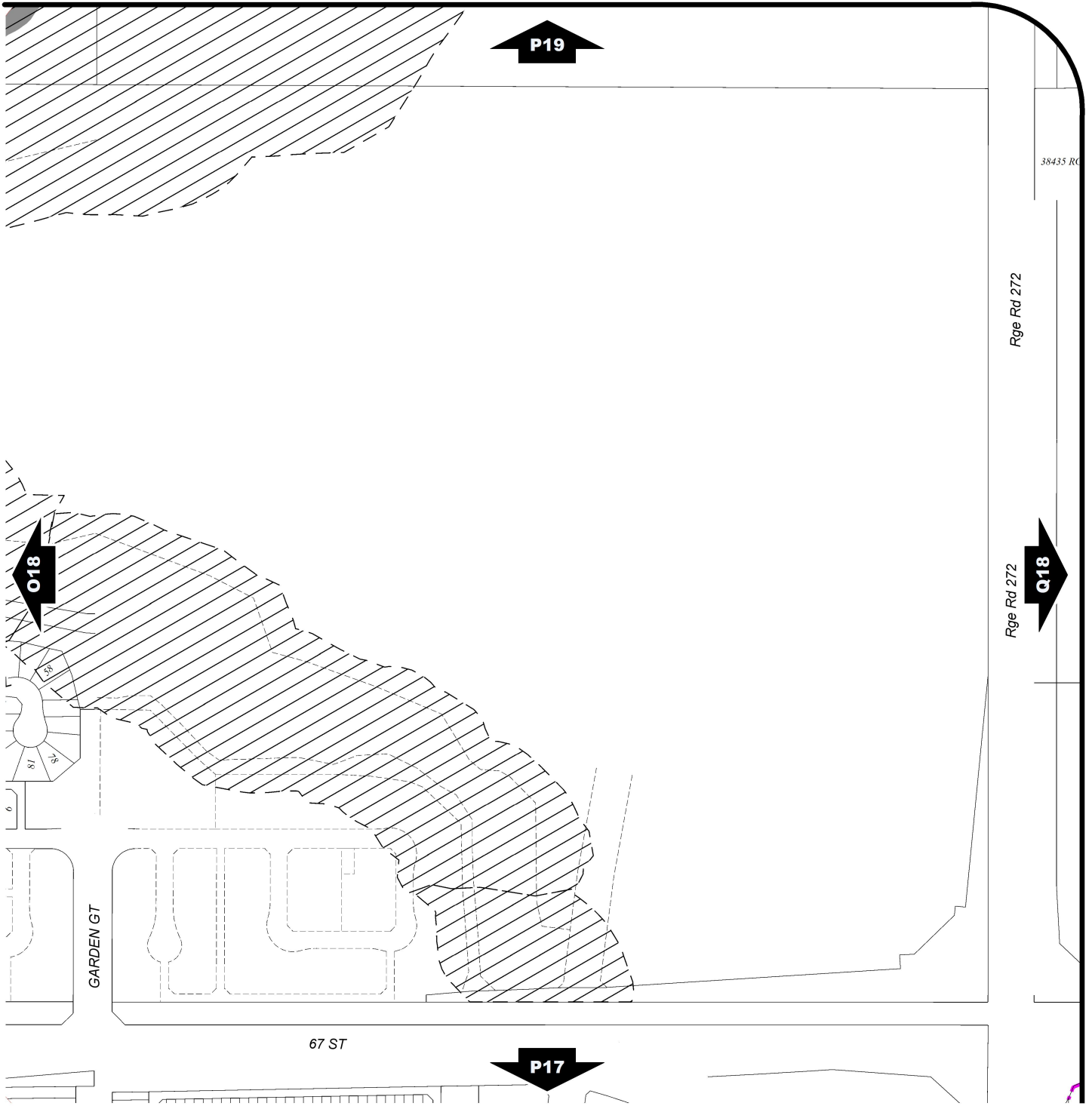

Land Use Bylaw 3357/2006



North

Scale 1:5,000

© The City of Red Deer



- | | |
|--|--------------------------------|
| Escarpment Area | Subdivision Consideration |
| Flood Fringe | Restricted Development Area |
| Floodway | Business Revitalization Zone |
| Landfill Site (approximate) | Historical Preservation Sites |
| Landfill Setback | Historically Significant Sites |
| Major Entry Area | Historical Site Number |
| TransCanada Pipeline Setback | City Boundary |
| AltaLink Consultation/Potential Constraints Area | Civic Address |
| Overlay District | Railway |
| Gaetz - Ross Heritage Area | Proposed Lots |

Printed on Nov 07, 2014

Land Use Constraints

P18

SE¼ Sec27 38-27-W4